

**Melissa Gordon** (b.1981) is an American artist based in London.

In the series *Material Evidence*, Gordon focuses on by-products of process on the surfaces of her studio by meticulously re-painting the autonomous gestural marks that accumulate over time. *Structures for Viewing* is a body of work that consists of repetitively silkscreened thick halftone lines, which create optically affective moirés and interfere with the hanging structures facing them. In the large black-and-white silkscreen *Malevich Blow Up*, Gordon zooms in on extreme details of male modernist paintings in catalogues, including damage and signs of aging.

**Lina Viste Grønli** (b.1976) is a Norwegian artist based in Cambridge, MA, and Oslo.

Linguistic and pragmatic incompetence 2008-14.

**Rob Johannesma** (b.1970) is a Dutch artist based in Amsterdam.

The photographic images selected for Johannesma's video works and screen prints are culled from the international press, which serves as a daily information resource for global events. Their mechanical reproducibility merges with the idealized construction of history in the tradition of European painting. Through their emphasis on gestures, movement and formal details, these narrative images add a new layer to our sense of reality. Ultimately, the archetypal language within art reflects our collective memory, which itself seems to be in a chronic crisis.

**Aukje Koks** (b.1977) is a Dutch artist based in Brussels.

The fragments in the works of Aukje Koks are instinctively selected and examined: the way in which a ball of rope is wound and its interior is made invisible, or a clothes hanger that looks like E.T. in the movie of the same name. These fragments, which are repeated, translated and then reunited, do not necessarily convey a message but rather provide a strange framework for thought in which they are stripped of their identity or function. During her work process the artist, furthermore, had images of Agatha Christie in mind.

**G. Küng** (b.1982) is an American artist based in Brussels.

Those of us in this show have been residents in WIELS and now we are exhibitors. This transition is full of significance. The group of objects I have made are constructed around the questions: what belongs where? What fits what? Who serves who? What is a joke and what is a warning?

**Cathérine Lommée** (b.1983) is a Belgian artist based in Brussels.

A straight line intersects a blind space, tracking a recurrence of cut surfaces. In the progression of this linear movement the line is folded in multiple directions – black-outs fade in, volumes emerge. As such the moving image activates a mode of growth paralleling the unfurling mechanism of narrative threads. Every line is a different fold. From a 'double act' of tracing the folds patterns take shape, expanding into a wider structure.

**Emmanuelle Quertain** (b.1987) is a Belgian artist based in Brussels.

*Studies on the notion of still life as sentence*, 2012  
Series of 5 paintings: oil on aluminium

- 1/5 Application, January
- 2/5 Application, January
- 3/5 Pushing a Colour (Yellow), February
- 4/5 Pushing a Colour + Preparatory Graphite Drawing, February
- 5/5 Preparatory Charcoal Drawing, August

**Grace Schwindt** (b.1979) is a German artist based in London.

*Untitled* and *Blue Dress* both arrive from the film *Tenant* that Grace Schwindt realised during her residency. At that time she expanded her practice and started working with sculpture using costumes from her film and performance works, aiming to create atmospheres and narratives through mixing different materials, including steel, wood and ceramics. The sculptures can be equally viewed from different angles, all presenting a different part of a narrative that can unfold in unique ways to each individual viewer.

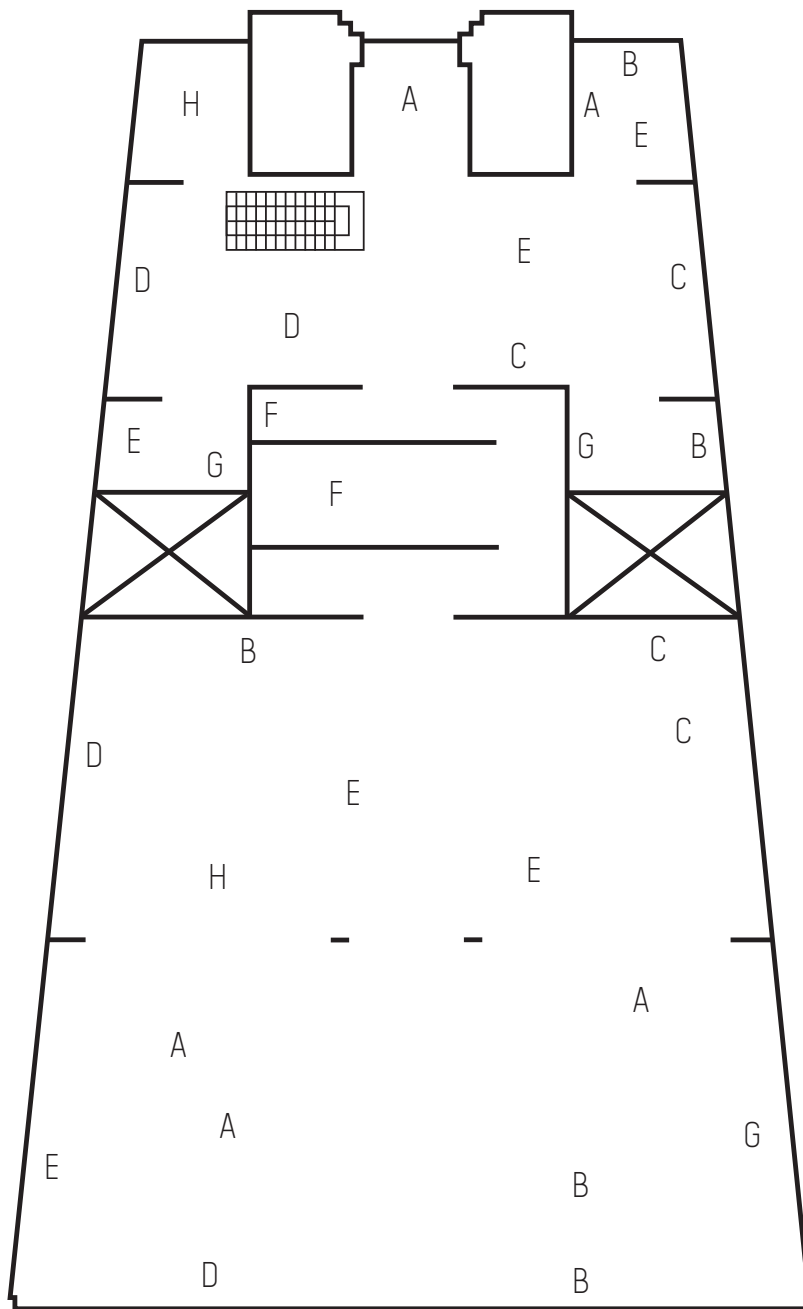

- A. Melissa Gordon
- B. Lina Viste Grønli
- C. Rob Johannesma
- D. Aukje Koks

- E. G. Küng
- F. Cathérine Lommée
- G. Emmanuelle Quertain
- H. Grace Schwindt

*During the Exhibition, the Studio Will Be Close*  
 14.06 – 17.08.2014  
 WIELS Contemporary Art Centre, Brussels